

## Manual for ilight with imop battery

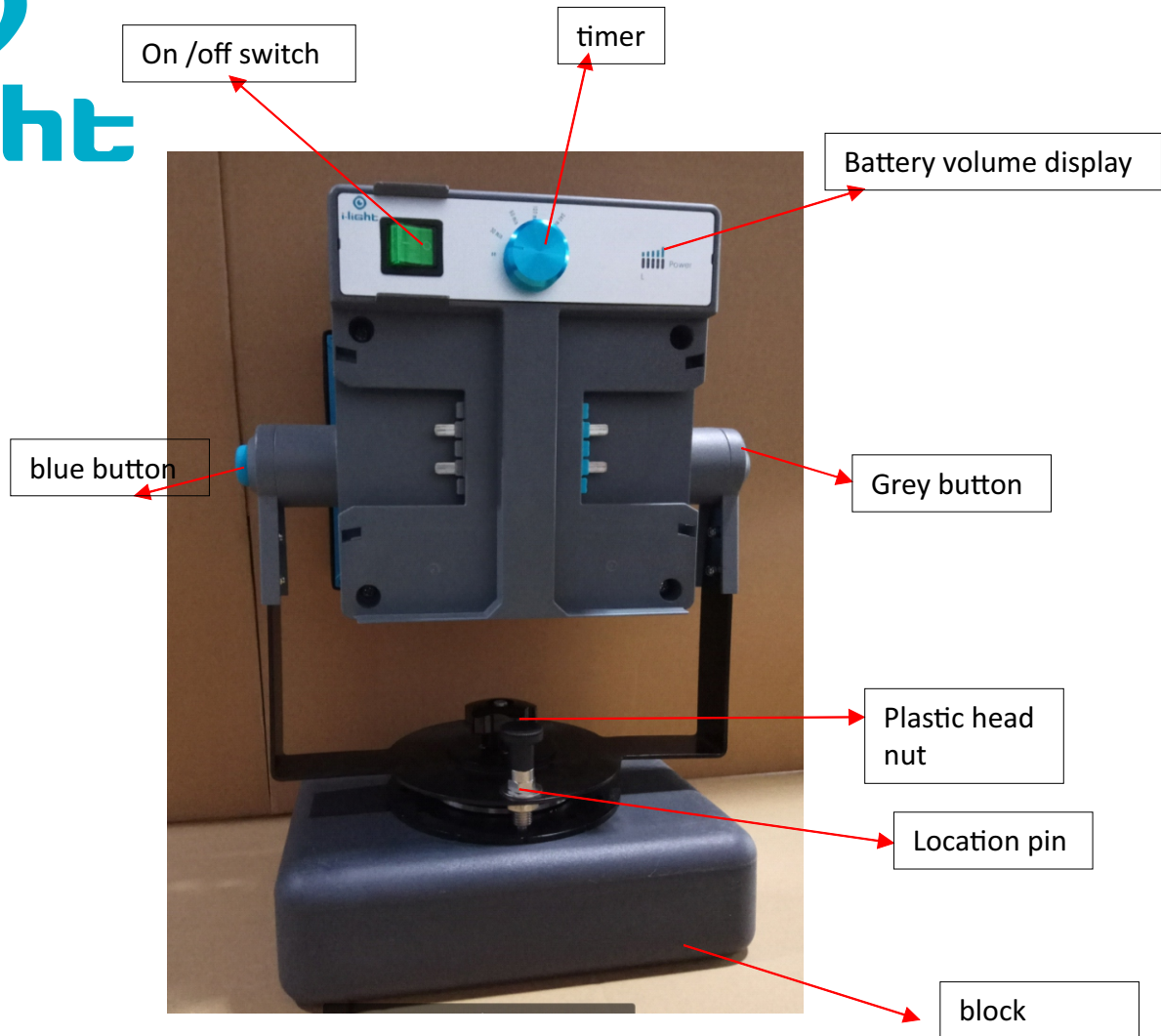

1. Use plastic head nut and M10 X 100 screw to fix the metal base on the block;
2. Insert the imop battery ;
3. Turn on the switch;
4. Use the timer to set up the time ;
5. Push the blue button to rotate the body up and down;
6. Lift the location pin and then rotate the body left and right, release the location pin after get the angle you wanted.

